

Hexagon head bolts

partially threaded

Tornillos con cabeza hexagonal

parcialmente roscados

六角头螺钉

部分螺纹

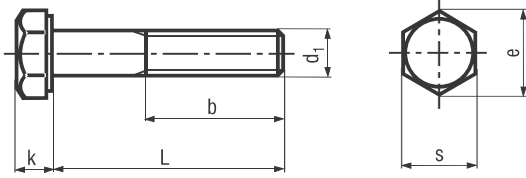

DIN 931

ISO 4014

○ A2
● A4

DIN 931: Standard withdrawn
Estándar descatálogo

d ₁	M5	M6	M8	M10	M12	(M14)	M16	M20	M24	(M27)	M30
b L ≤ 125	16	18	22	26	30	34	38	46	54	60	66
b L > 125 ≤ 200	22	24	28	32	36	40	44	52	60	66	72
b L > 200				45	49	53	57	65	73	79	85
e	0,79	11,05	14,30	10,90	21,10	24,49	26,75	33,53	39,90	45,2	50,05
k	3,5	4	5,3	6,4	7,5	8,8	10	12,5	15	17	18,7
s	8	10	13	17,16*	19,18*	22,21*	24	30	36	41	46

* Wrench size according to ISO on request
Entrecaras según ISO previa petición



The commercial quality is class A2-70 and A4-70 (tensile strength 700 N/mm²) for thread diameters M5 - M24 and with lengths up to 8x thread diameter (8xd).

La calidad habitual es la clase de resistencia A2-70 / A4-70 (resistencia a la tracción 700 N/mm²) para los diámetros comprendidos entre M5 y M24 y longitudes hasta 8x el diámetro de la rosca (8xd).



Mechanical properties, Chemical composition, Tightening torques, etc.
Propiedades mecánicas, composición química, pares de apriete, etc.

BN 623				○ A2							
d ₁	L	☐ / ☐	☐	d ₁	L	☐ / ☐	☐	d ₁	L	☐ / ☐	☐
M5	30	●	100	M8	40	●	100	M10	90	●	50
	35	●	100		45	●	100		100	●	50
	40	●	100		50	●	100		110	●	50
	45	●	100		55	●	100		120	●	50
	50	●	100		60	●	100		130	●	50
	55	●	100		65	●	100		140	●	50
M6	60	●	100	70	●	100	150	●	50		
	30	●	100	(75)	●	100	160	●	25		
	35	●	100	80	●	50	180	●	25		
	40	●	100	90	●	50	200	●	25		
	45	●	100	100	●	50	M12	45	●	50	
	50	●	100	110	●	50		50	●	50	
	55	●	100	120	●	50		55	●	50	
	60	●	100	130	●	50		60	●	50	
	65	●	100	140	●	50		65	●	50	
	70	●	100	150	●	50		70	●	50	
	(75)	●	100	160	●	25	(75)	●	50		
	80	●	100	180	●	25	80	●	50		
	90	●	100	200	●	25	90	●	50		
	100	●	100	M10	40	●	100	100	●	25	
110	●	100	45		●	100	110	●	25		
120	●	100	50		●	100	120	●	25		
130	●	100	55		●	50	130	●	25		
140	●	100	60		●	50	140	●	25		
150	●	100	65		●	50	150	●	25		
160	●	50	70	●	50	160	●	25			
180	●	50	(75)	●	50	180	●	25			
M8	35	●	100	80	●	50	200	●	25		

Hexagon head bolts

partially threaded

Tornillos con cabeza hexagonal

parcialmente roscados

六角头螺钉

部分螺纹

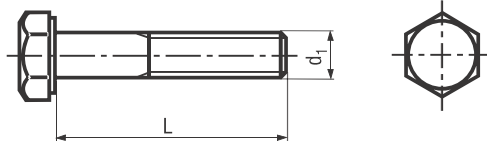

DIN 931

ISO 4014

○ A2
● A4

DIN 931: Standard withdrawn
Estándar descatálogo

BN 623				○ A2							
d ₁	L	▨ / 齿	⊞	d ₁	L	▨ / 齿	⊞	d ₁	L	▨ / 齿	⊞
M16	50	●	25	M20	(75)	●	25	M24	160	●	1
	55	●	25		80	●	25		180	●	1
	60	●	25		90	●	25		200	●	1
	65	●	25		100	●	25	(M27)	80	●	1
	70	●	25		110	●	1		90	●	1
	(75)	●	25		120	●	1		100	●	1
	80	●	25		130	●	1		120	●	1
	90	●	25		140	●	1		140	●	1
	100	●	25		150	●	1	M30	80	●	1
	110	●	25		160	●	1		90	●	1
	120	●	25		180	●	1		100	●	1
	130	●	25		200	●	1		110	●	1
	140	●	25		M24	80	●		1	120	●
	150	●	25			90	●	1	140	●	1
	160	●	25			100	●	1	150	●	1
	180	●	25			110	●	1	160	●	1
	200	●	25			120	●	1	180	●	1
M20	65	●	25	140	●	1	200	●	1		
	70	●	25	150	●	1					

BN 625				● A4							
d ₁	L	▨ / 齿	⊞	d ₁	L	▨ / 齿	⊞	d ₁	L	▨ / 齿	⊞
M5	30	●	100	M6	130	●	100	M8	160	●	25
	35	●	100		140	●	100		180	●	25
	40	●	100		150	●	100		200	●	25
	45	●	100		160	●	50	M10	40	●	100
	50	●	100	180	●	50	45		●	100	
	55	●	100	M8	35	●	100		50	●	100
60	●	100	40		●	100	55		●	50	
M6	30	●	100		45	●	100		60	●	50
	35	●	100		50	●	100	65	●	50	
	40	●	100		55	●	100	70	●	50	
	45	●	100	60	●	100	(75)	●	50		
	50	●	100	65	●	100	80	●	50		
	55	●	100	70	●	100	90	●	50		
	60	●	100	(75)	●	100	100	●	50		
	(65)	●	100	80	●	50	110	●	50		
	70	●	100	90	●	50	120	●	50		
	(75)	●	100	100	●	50	130	●	50		
	80	●	100	110	●	50	140	●	50		
	90	●	100	120	●	50	150	●	50		
100	●	100	130	●	50	160	●	25			
110	●	100	140	●	50	180	●	25			
120	●	100	150	●	50	200	●	25			

Hexagon head bolts

partially threaded

Tornillos con cabeza hexagonal

parcialmente roscados

六角头螺钉

部分螺纹

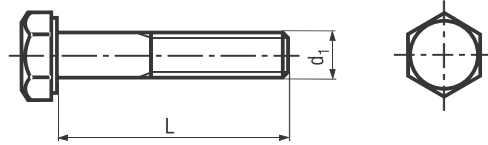

DIN 931

ISO 4014

○ A2
● A4

DIN 931: Standard withdrawn
Estándar descatálogo

BN 625				● A4							
d ₁	L	▨ / 个	📦	d ₁	L	▨ / 个	📦	d ₁	L	▨ / 个	📦
M12	45	●	50	(M14)	120	●	25	M20	70	●	25
	50	●	50		130	●	25		(75)	●	25
	55	●	50		140	●	25		80	●	25
	60	●	50		150	●	25		90	●	25
	65	●	50		160	●	25		100	●	25
	70	●	50		M16	50	●		25	110	●
	(75)	●	50	55		●	25		120	●	1
	80	●	50	60		●	25		130	●	1
	90	●	50	65		●	25		140	●	1
	100	●	25	70		●	25		150	●	1
	110	●	25	(75)		●	25	160	●	1	
	120	●	25	80		●	25	180	●	1	
	130	●	25	90		●	25	200	●	1	
	140	●	25	100		●	25	220	●	1	
	150	●	25	110		●	25	240	●	1	
	160	●	25	120	●	25	M24	80	●	1	
	180	●	25	130	●	25		90	●	1	
	200	●	25	140	●	25		100	●	1	
	(M14)	50	●	25	150	●		25	120	●	1
		60	●	25	160	●		25	140	●	1
70		●	25	180	●	25		160	●	1	
80		●	25	200	●	25	180	●	1		
90		●	25	220	●	10	200	●	1		
100		●	25	M20	60	●	25	220	●	1	
110	●	25	65		●	25	240	●	1		

Hexagon head screws / bolts UNC
Tornillos con cabeza hexagonal UNC
 六角头螺钉/螺栓 英制粗牙

UNC ~DIN 931
● A4

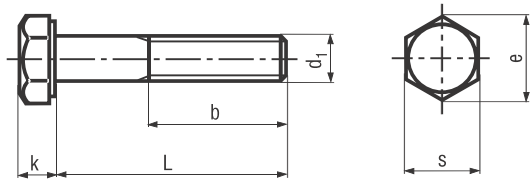

d ₁	1/4"	5/16"	3/8"	1/2"
b	19	22	25	32
e	12,8	14,7	16,5	22
k	4	5,2	6	7,9
s	7/16"	1/2"	9/16"	3/4"

BN 627				● A4			
d ₁	L	▨ / ▩	☐	d ₁	L	▨ / ▩	☐
1/4"	3/4"	●	100	5/16"	1 1/2"	●	100
	7/8"	●	100		1 3/4"	●	100
	1"	●	100		2"	●	100
	1 1/4"	●	100	3/8"	1"	●	50
1 1/2"	●	100	1 1/4"		●	50	
1 3/4"	●	100	1 1/2"		●	50	
5/16"	1"	●	100	1 3/4"	●	50	50
	1 1/4"	●	100				

Slotted hexagon head screws
 fully threaded
Tornillos con cabeza hexagonal ranurada
 totalmente roscados
 开槽六角头螺钉
 全螺纹

DIN 933 Sz
○ A2

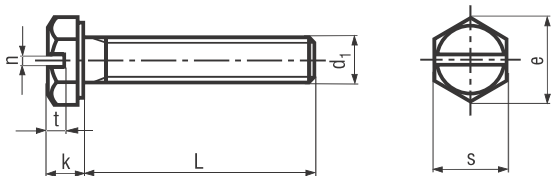

d ₁	M4	M5	M6
e	7,66	8,79	11,05
k	2,8	3,5	4
s	7	8	10
n min. ¹⁾	1,06	1,26	1,66
t min. ¹⁾	1,12	1,4	1,6

¹⁾ Slot according DIN 962
 Ranura según DIN 962

DIN 933: Standard withdrawn
 Estándar descatálogo

BN 4965				○ A2			
d ₁	L	▨ / ▩	☐	d ₁	L	▨ / ▩	☐
M4	8	●	100	M5	16	●	100
	10	●	100		20	●	100
	12	●	100		25	●	100
	16	●	100		30	●	100
M5	10	●	100	M6	10	●	100
	12	●	100		12	●	100