

# PRIVARILNE PUŠE

## No-Threaded-Stud UT

before welding

after welding

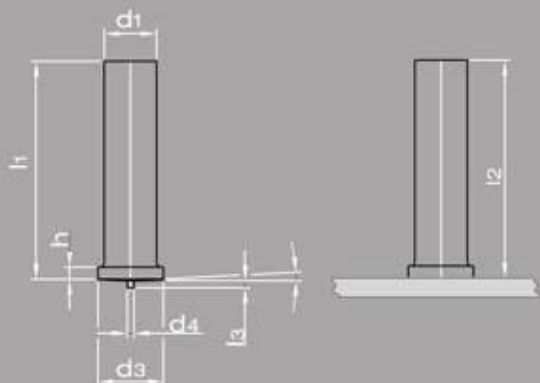

$$l_1 \approx l_2 + 0,3\text{mm}$$

$d_1 \pm 0,1$	3	4	5	6	7,1
$d_3 \pm 0,2$	4,5	5,5	6,5	7,5	9,0
$d_4 \pm 0,08$	0,60	0,65	0,75	0,75	0,75
$l_3 \pm 0,05$	0,55	0,55	0,8	0,8	0,85
$h$	0,7 bis 1,4	0,7 bis 1,4	0,8 bis 1,4	0,8 bis 1,4	0,8 bis 1,4
$a \pm 1^\circ$	3°	3°	3°	3°	3°
$l_2 + 0,6^{*)}$	weight about (7,85 kg/dm <sup>3</sup> ) per 1.000pcs in kg (St.37)				
0					
8	0,420	0,670	1,150	1,600	2,500
10	0,492	0,800	1,350	1,850	3,300
12	0,540	0,950	1,600	2,100	3,800
15	0,640	1,180	1,950	2,650	4,800
20	0,820	1,540	2,550	3,400	6,500
25	0,980	1,920	3,150	4,150	7,800

Material selection: Other materials according agreement

ISO-Standard	4.8	A2-50
Old Description	St. 37 verk.	1.4301
Product Key	21-XXX-XXXX	22-XXX-XXXX

Ordering sample UT 3x8 aus A2-50 = Art.-Nr.: 22-003-0008

before welding

after welding

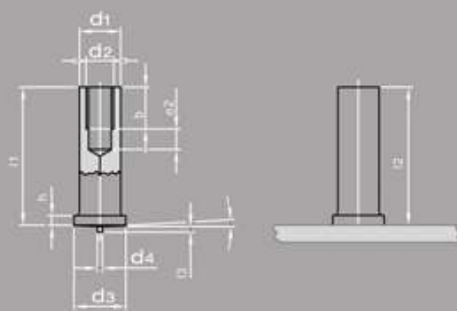

$$l_1 \approx l_2 + 0,3\text{mm}$$

## Tapped Studs IT

$d_2$	M3	M4	M5
$d_1 \pm 0,1$	5	6	7,1
$d_3 \pm 0,2$	6,5	7,5	9
$d_4 \pm 0,08$	0,75	0,75	0,75
$l_3 \pm 0,05$	0,80	0,80	0,85
$b + 0,5^{*)}$	5	6	7,5
- 0			
$h$	0,8 to 1,4	0,8 to 1,4	0,8 to 1,4
$e_{\min}$	2,5	3	3
$a \pm 0,1^\circ$	3°	3°	3°
$l_2 + 0,6^{*)}$	weight about (7,85 kg/dm <sup>3</sup> ) per 1.000pcs in kg (St. 37)		
0			
10	1,24	1,64	2,37
12	1,51	1,98	2,68
16	2,10	3,10	3,80
20	2,77	3,80	4,88
25	3,59	4,90	6,80

\*) other length according agreement

Material selection: Other materials according agreement

ISO-Standard	4.8	A2-50
Old Description	St. 37 verk.	1.4301
Product Key	31-0XX-XXXX	32-0XX-XXXX

Ordering sample IT 5 M3x10 of A2-50 = Art.No. 32-035-0010